

## About Data Transmission Function

This instrument stores maximum number of 100 measurement data. This instrument is equipped with NFC (Near Field Communication) technology. Data history can be accessed by bringing PAL-NFC to any Android devices or PC-linked USB NFC Reader/Writer\* (in conformance to PC/SC specification).  
\* Operation tested with SONY USB NFC Reader PaSoRi RC-S380.

**Caution** Data history exceeding 100 will overwrite old activity with new data, replacing the oldest recorded information first.

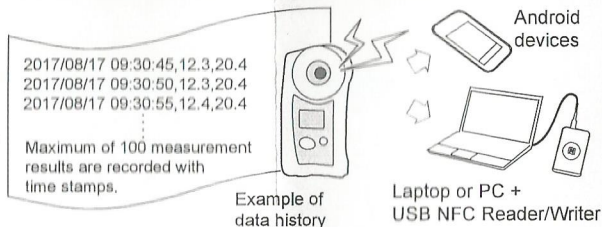

Example of data history

Laptop or PC + USB NFC Reader/Writer

### Preparation

#### (1) Software installation

Install a software to readout the NFC tag ahead of time.

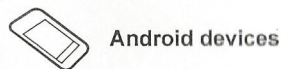

#### Android devices

Applicable Application Software (app) "NFC Reader"  
\* If an NFC tag reader app is already installed on the Android devices, this app can be used.



#### Laptop or PC + USB NFC Reader/Writer

Data history can be exported to Microsoft<sup>®</sup> Excel<sup>®</sup> (for Windows<sup>®</sup>) using a PAL NFC software "ATAGO Logger (NFC)."  
\* The app "ATAGO Logger (NFC)" is available for download : <http://www.atago.net/ur/>

2017/08/17 09:30:45	LLL	20.5
2017/08/17 09:31:50	12.3	20.4
2017/08/17 09:32:12	12.3	20.4
2017/08/17 09:34:26	AAA	20.4
2017/08/17 09:43:07	OOO	20.4
2017/08/17 09:43:18	OOO	20.3
2017/08/17 09:45:39	26.9	20.3
2017/08/17 09:46:07	26.9	20.1

Example of data history read out

LLL : Lower limit error. HHH : Upper limit error.  
OOO : Zero setting complete. nnn : External light error.  
AAA : Zero setting error.

#### (2) Date and time setting

Set the date and time (year (the last two digits of the western calendar), month, date, time and minute) prior to data history readout.

**memo** Reset the date and time when batteries are removed for 24hours or more.

While powered on...  
(Example image)

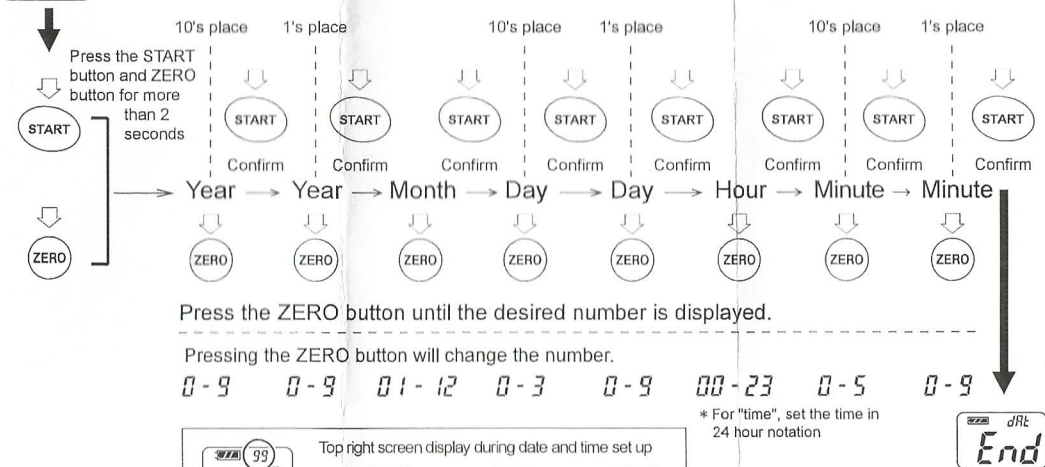

(Seconds : Fixed 00)

## Data history readout

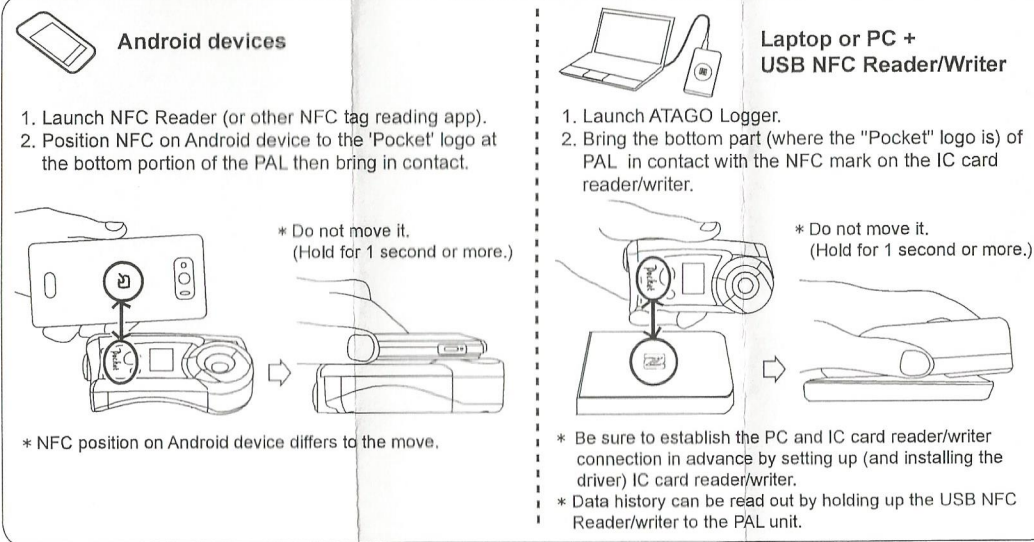

**All recorded data stored in this instrument are read out.**

\* If data history is not read out, bring both in contact and move the one that is over the other device in a forward and back or left and right in a small motion.

**Caution** Bring PAL and Android devices or PAL and USB NFC Reader/writer as close to each other as possible. (Position it so that the distance between both devices are 5mm or less.)

**memo** Data history can be read out while PAL is powered off.  
**memo** Data history readout will not delete the stored data history.

### Delete data history

All data history will be deleted from this instrument.  
**Caution** Deleted data history can not be restored.  
**memo** A data history can not be selected.

While powered on...  
(Example image) 1. Quickly (3 seconds or less) do the following button operation.

(a) While pressing the START button, press the ZERO button two times.

(b) Quickly release the START button.

